

DOOR LOCKS

PRODUCT CATALOG

Fashion Life, Start From Here

LOCK BODY
CYLINDER



HIGH QUALITY DOOR LOCK



DOOR LOCKS

LOCK BODY
CYLINDER



Fashion Life, Start From Here



DOOR LOCKS

Lock Body Cylinder

简约风

满满的韵味，足足的气息，走出来的是脚印，留下来的是传颂，任谁都看得出这样的智慧。

Contracted wind

Full of charm, full of flavor, walked out of the footprints, stayed, is famed as anyone can see that this wisdom.



BEST Products Leading The Trend

DOOR LOCKS



010-263



205-263



140-263



134-263



207-263



014-075



014-075



140-075



206-075



134-263



207-263



014-075



208-075



209-625



142-625

DOOR LOCKS

DOOR LOCKS



223-625



238-625



239-6102



131-444



138-444



243-698

DOOR LOCKS



240-697



241-696



242-445



244-685



228-443



141-619

DOOR LOCKS



223-448



205-447



228-446



229-454



230-259



231-453



142-449



232-450



233-451



234-676



235-447



210-452

DOOR LOCKS

DOOR LOCKS



210-641



210-619



211-667



212-625



144-66



213-455



214-6391



145-68



215-013



216-457



217-456



143-6114

DOOR LOCKS

DOOR LOCKS



002-211



002-211



002-037



002-015



002-202



002-202

DOOR LOCKS



063-004



063-301



224-003



003-041



002-039



003-039

DOOR LOCKS



020-069



020-254



108-101



104-103



041-213



204-458

DOOR LOCKS



011-264



001-003



020-090



090-274



004-143



004-459

DOOR LOCKS



7024-038



006-460



004-004



004-301



218-305



219-341

DOOR LOCKS



004-301



162-253



167-253



040-253



040-004



040-307

DOOR LOCKS



228-263



205-611



227-462



223-461



225-472



226-471



131-64



220-075



221-611



222-463



224-464



143-465

DOOR LOCKS

DOOR LOCKS



009-262



237-262



134-471



002-470



002-470



002-469

DOOR LOCKS



002-473



020-468



108-101



015-002



236-472



141-263

DOOR LOCKS



240S-101



224S-211



241S-103



041S-213



003S-041



023S-213

简而雅的实质

褪却一切繁杂，回归最本真的奢华

The essence of Jane and elegant

Fade all multifarious, return to the authenticity of luxury



BEST Products Leading The Trend

DOOR LOCKS



293



007



100



297



090



261

DOOR LOCKS



069



014



295



071



034



039

DOOR LOCKS



003



004



090



297



211



271

DOOR LOCKS



039



100



071



007



043



002

DOOR LOCKS



239



069



263



271



229



392

DOOR LOCKS



064



009



317



001



323



027

DOOR LOCKS



190



098



029



016



095



006

DOOR LOCKS



320



021



305



271



251



312

DOOR LOCKS



211



034



007



249



040



294

DOOR LOCKS



393



394



395



252



101



396

DOOR LOCKS



137



268



235

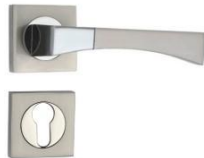

265



313



397

DOOR LOCKS



398



399



400



401



402



061

DOOR LOCKS



361



362



175



363



213



292



073



079

DOOR LOCKS



367



204



025



366



364



365



404



405

DOOR LOCKS



255



090A



319



060



285



192



318



087

DOOR LOCKS



288



003



305



043



318



048



036



283

DOOR LOCKS



244



019



160



059



090



441



044



234

DOOR LOCKS



140



225



069



229



305



410



263



233

DOOR LOCKS



069



003



060



071



003



190



040



035

DOOR LOCKS



101



006



212



113



273



223



304



032

DOOR LOCKS



021



228



271



064



001



097



283



004

DOOR LOCKS



020



048



203



253



039



290



369



370

DOOR LOCKS



027



131



442



014



070



030



038



160

DOOR LOCKS



134



055



411



412



413



414



415



250

DOOR LOCKS



416



417



418



419



420



421



422



423

DOOR LOCKS



424



425



426



378



379



427



040



086

DOOR LOCKS



377



024



428



429



380



294



071



014

DOOR LOCKS



264



239



317



042



075



095



037



431

DOOR LOCKS



069



037



070



381



368



382



036



009

DOOR LOCKS



007



080



045



101



160



049



029



024

DOOR LOCKS



101



238



037



383



088



040



020



384

DOOR LOCKS



385



387



386



388



164



389



391



390

DOOR LOCKS



432



433



434



435



436



437



313



241

DOOR LOCKS



268



236



438



439



286



037



068



160

DOOR LOCKS



101



238

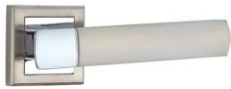

037



383



088



040



020



384

淡雅，舒适、安逸平和宁静自然与人性的和谐，美只能融入到人的心灵深处。

Quietly elegant, comfortable, easy and comfortable peace between nature and human nature Beauty of harmony, can only be incorporated into the depths of the soul.



BEST Products Leading The Trend

STAINLESS DOOR HANDLE



S001-000



S001-372



S002-373



S001-002



S002-467



S002-466

STAINLESS DOOR HANDLE



375



440



699



700



372



371



374



373

LOCK BODY SERIES

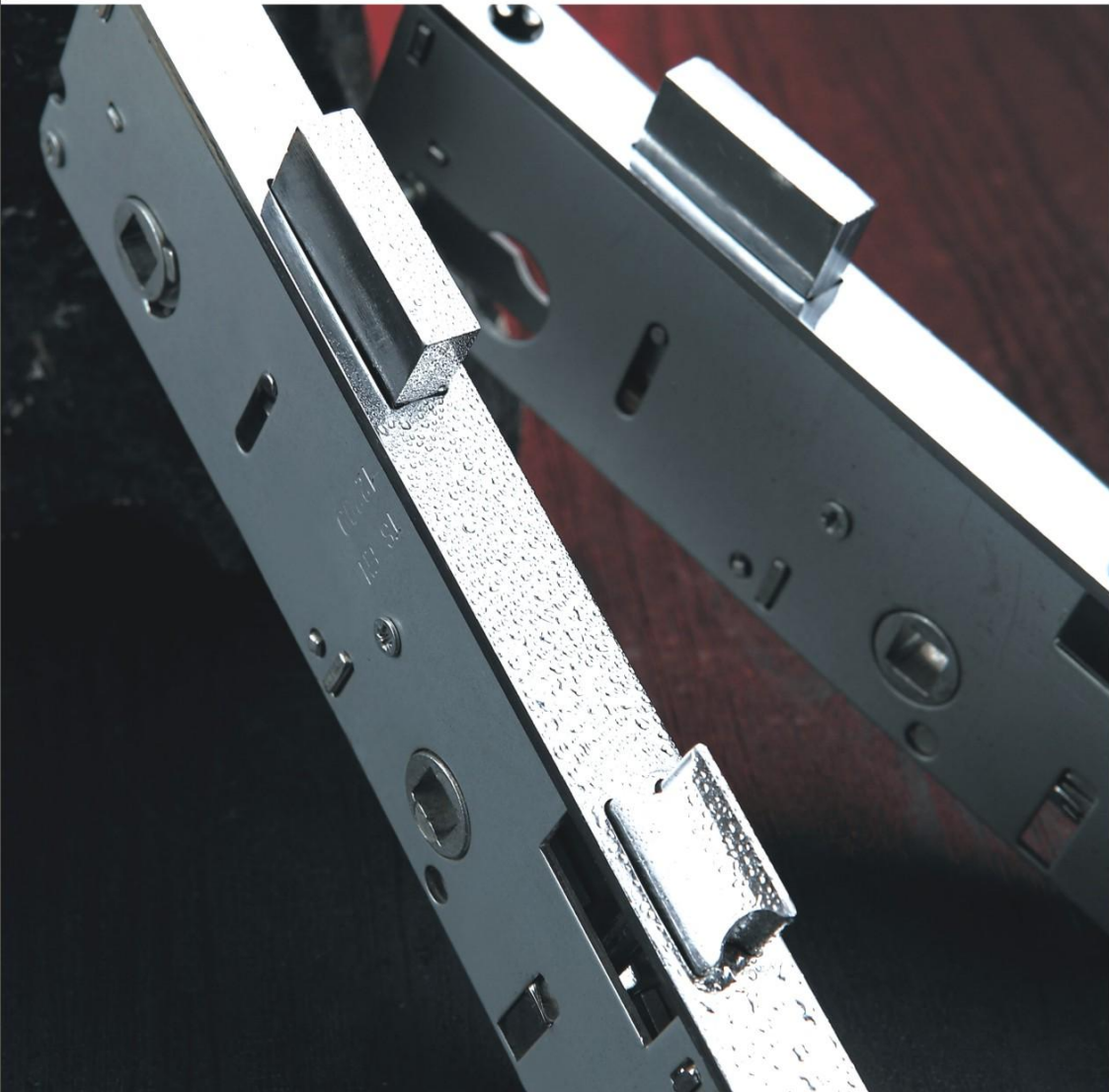

HX7011-45 BC

TECHNICAL DATA

- Follower/方芯: 8mm
- Distance/中心距: 85mm
- Backset/门距: 45mm

FDREND

- Type/类型: Round head/圆头 Square head/方头
- Thickness/厚度: 2.5mm 3.0mm
- Width/宽度: 22mm
- Finishes/表面处理: NB/AB/PB/SN/CP/GP

MATERIAL

- Latch bolt/斜舌: Brass/铜 Zinc Alloy/锌合金
- Dead bolt/方舌: Brass/铜 Zinc Alloy/锌合金
Steel/铁
- Forend/面板: Brass/铜 Stainless steel/不锈钢
Steel/铁

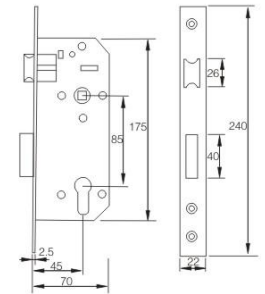

HX7016-45

TECHNICAL DATA

- Follower/方芯: 8mm
- Distance/中心距: 85mm
- Backset/门距: 45mm

FDREND

- Type/类型: Round head/圆头 Square head/方头
- Thickness/厚度: 2.5mm 3.0mm
- Width/宽度: 22mm
- Finishes/表面处理: NB/AB/PB/SN/CP/GP

MATERIAL

- Latch bolt/斜舌: Brass/铜 Zinc Alloy/锌合金
- Dead bolt/方舌: Brass/铜 Zinc Alloy/锌合金
Steel/铁
- Forend/面板: Brass/铜 Stainless steel/不锈钢
Steel/铁

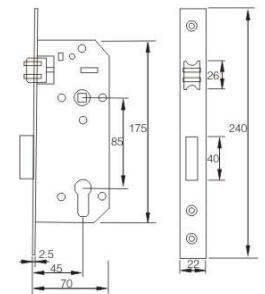

LOCK BODY SERIES



HX7011-45 A

TECHNICAL DATA

- Follower/方芯: 8mm
- Distance/中心距: 85mm
- Backset/门距: 45mm

FDREND

- Type/类型: Round head/圆头 Square head/方头
- Thickness/厚度: 2.5mm 3.0mm
- Width/宽度: 22mm
- Finishes/表面处理: NB/AB/PB/SN/CP/GP

MATERIAL

- Latch bolt/斜舌: Brass/铜 Zinc Alloy/ 锌合金
- Dead bolt/方舌: Brass/铜 Zinc Alloy/ 锌合金 Steel/铁
- Forend/面板: Brass/铜 Stainless steel/ 不锈钢 Steel/铁

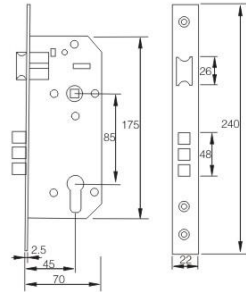

LOCK BODY SERIES



HX7011-40 D

TECHNICAL DATA

- Follower/方芯: 8mm
- Distance/中心距: 85mm
- Backset/门距: 40mm

FDREND

- Type/类型: Round head/圆头 Square head/方头
- Thickness/厚度: 2.5mm 3.0mm
- Width/宽度: 22mm
- Finishes/表面处理: NB/AB/PB/SN/CP/GP

MATERIAL

- Latch bolt/斜舌: Brass/铜 Zinc Alloy/ 锌合金
- Dead bolt/方舌: Brass/铜 Zinc Alloy/ 锌合金 Steel/铁
- Forend/面板: Brass/铜 Stainless steel/ 不锈钢 Steel/铁

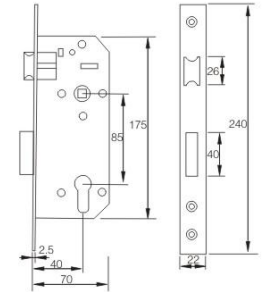

HX7011-45 B

TECHNICAL DATA

- Follower/方芯: 8mm
- Distance/中心距: 85mm
- Backset/门距: 45mm

FDREND

- Type/类型: Round head/圆头 Square head/方头
- Thickness/厚度: 2.5mm 3.0mm
- Width/宽度: 22mm
- Finishes/表面处理: NB/AB/PB/SN/CP/GP

MATERIAL

- Latch bolt/斜舌: Brass/铜 Zinc Alloy/ 锌合金
- Dead bolt/方舌: Brass/铜 Zinc Alloy/ 锌合金 Steel/铁
- Forend/面板: Brass/铜 Stainless steel/ 不锈钢 Steel/铁

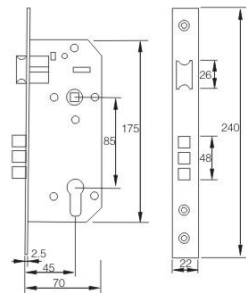

HX7011-40 A

TECHNICAL DATA

- Follower/方芯: 8mm
- Distance/中心距: 85mm
- Backset/门距: 40mm

FDREND

- Type/类型: Round head/圆头 Square head/方头
- Thickness/厚度: 2.5mm 3.0mm
- Width/宽度: 22mm
- Finishes/表面处理: NB/AB/PB/SN/CP/GP

MATERIAL

- Latch bolt/斜舌: Brass/铜 Zinc Alloy/ 锌合金
- Dead bolt/方舌: Brass/铜 Zinc Alloy/ 锌合金 Steel/铁
- Forend/面板: Brass/铜 Stainless steel/ 不锈钢 Steel/铁

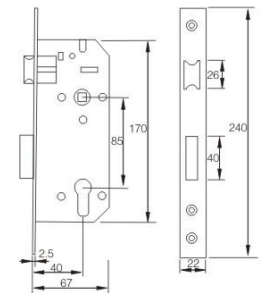

LOCK BODY SERIES



HX7011-40 B

TECHNICAL DATA

- Follower/方芯: 8mm
- Distance/中心距: 85mm
- Backset/门距: 40mm

FDREND

- Type/类型: Round head/圆头 Square head/方头
- Thickness/厚度: 2.5mm 3.0mm
- Width/宽度: 22mm
- Finishes/表面处理: NB/AB/PB/SN/CP/GP

MATERIAL

- Latch bolt/斜舌: Brass/铜 Zinc Alloy/ 锌合金
- Dead bolt/方舌: Brass/铜 Zinc Alloy/ 锌合金 Steel/铁
- Forend/面板: Brass/铜 Stainless steel/ 不锈钢 Steel/铁

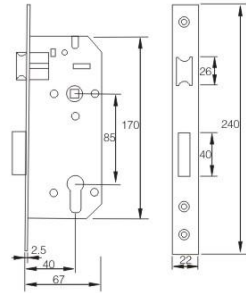

LOCK BODY SERIES



H70-20A

TECHNICAL DATA

- Follower/方芯: 无
- Distance/中心距: 70mm
- Backset/门距: 20mm

FDREND

- Type/类型: Round head/圆头 Square head/方头
- Thickness/厚度: 2.5mm 3.0mm
- Width/宽度: 22mm
- Finishes/表面处理: NB/AB/PB/SN/CP/GP

MATERIAL

- Latch bolt/斜舌: Brass/铜 Zinc Alloy/ 锌合金
- Dead bolt/方舌: Brass/铜 Zinc Alloy/ 锌合金 Steel/铁
- Forend/面板: Brass/铜 Stainless steel/ 不锈钢 Steel/铁

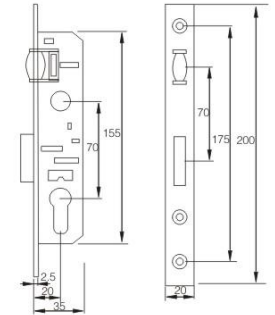

F58-45A

TECHNICAL DATA

- Follower/方芯: 8mm
- Distance/中心距: 58mm
- Backset/门距: 45mm

FDREND

- Type/类型: Round head/圆头 Square head/方头
- Thickness/厚度: 2.5mm 3.0mm
- Width/宽度: 22mm
- Finishes/表面处理: NB/AB/PB/SN/CP/GP

MATERIAL

- Latch bolt/斜舌: Brass/铜 Zinc Alloy/ 锌合金
- Dead bolt/方舌: Brass/铜 Zinc Alloy/ 锌合金 Steel/铁
- Forend/面板: Brass/铜 Stainless steel/ 不锈钢 Steel/铁

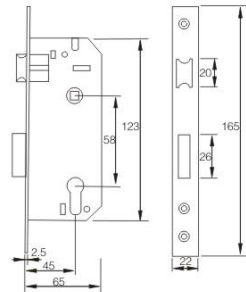

H70-20B

TECHNICAL DATA

- Follower/方芯: 8mm
- Distance/中心距: 70mm
- Backset/门距: 20mm

FDREND

- Type/类型: Round head/圆头 Square head/方头
- Thickness/厚度: 2.5mm 3.0mm
- Width/宽度: 22mm
- Finishes/表面处理: NB/AB/PB/SN/CP/GP

MATERIAL

- Latch bolt/斜舌: Brass/铜 Zinc Alloy/ 锌合金
- Dead bolt/方舌: Brass/铜 Zinc Alloy/ 锌合金 Steel/铁
- Forend/面板: Brass/铜 Stainless steel/ 不锈钢 Steel/铁

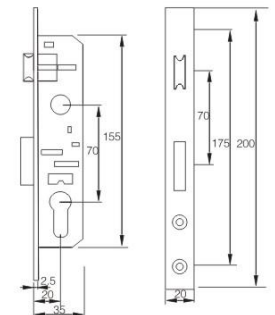

LOCK BODY SERIES



HX05-192

TECHNICAL DATA

- Follower/方芯: 8mm
- Distance/中心距: 72mm
- Backset/门距: 50/55/60/65mm

FDREND

- Type/类型: Round head/圆头 Square head/方头
- Thickness/厚度: 2.5mm 3.0mm
- Width/宽度: 23mm
- Finishes/表面处理: NB/AB/PB/SN/CP/GP

MATERIAL

- Latch bolt/斜舌: Brass/铜 Zinc Alloy/ 锌合金
- Dead bolt/方舌: Brass/铜 Zinc Alloy/ 锌合金 Steel/铁
- Forend/面板: Brass/铜 Stainless steel/ 不锈钢 Steel/铁

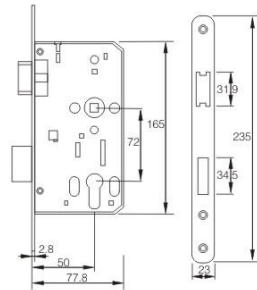

LOCK BODY SERIES



HX07-221

TECHNICAL DATA

- Follower/方芯: 8mm
- Distance/中心距: 72mm
- Backset/门距: 55mm

FDREND

- Type/类型: Round head/圆头 Square head/方头
- Thickness/厚度: 2.5mm 3.0mm
- Width/宽度: 23mm
- Finishes/表面处理: NB/AB/PB/SN/CP/GP

MATERIAL

- Latch bolt/斜舌: Brass/铜 Zinc Alloy/ 锌合金
- Dead bolt/方舌: Brass/铜 Zinc Alloy/ 锌合金 Steel/铁
- Forend/面板: Brass/铜 Stainless steel/ 不锈钢 Steel/铁

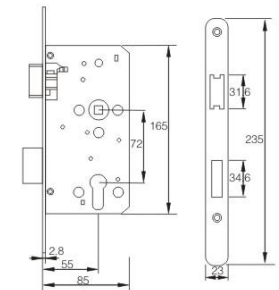

HX06-196

TECHNICAL DATA

- Follower/方芯: 8mm
- Distance/中心距: 72mm
- Backset/门距: 40/45/50/55mm

FDREND

- Type/类型: Round head/圆头 Square head/方头
- Thickness/厚度: 2.5mm 3.0mm
- Width/宽度: 23mm
- Finishes/表面处理: NB/AB/PB/SN/CP/GP

MATERIAL

- Latch bolt/斜舌: Brass/铜 Zinc Alloy/ 锌合金
- Dead bolt/方舌: Brass/铜 Zinc Alloy/ 锌合金 Steel/铁
- Forend/面板: Brass/铜 Stainless steel/ 不锈钢 Steel/铁

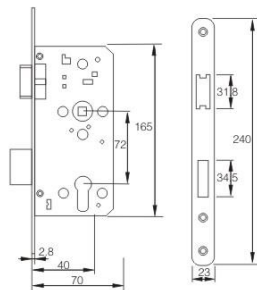

HX09-281

TECHNICAL DATA

- Follower/方芯: 8mm
- Distance/中心距: 72mm
- Backset/门距: 55mm

FDREND

- Type/类型: Round head/圆头 Square head/方头
- Thickness/厚度: 2.5mm 3.0mm
- Width/宽度: 18mm
- Finishes/表面处理: NB/AB/PB/SN/CP/GP

MATERIAL

- Latch bolt/斜舌: Brass/铜 Zinc Alloy/ 锌合金
- Dead bolt/方舌: Brass/铜 Zinc Alloy/ 锌合金 Steel/铁
- Forend/面板: Brass/铜 Stainless steel/ 不锈钢 Steel/铁

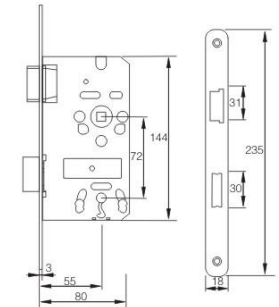

LOCK BODY SERIES



HX11-R-191

TECHNICAL DATA

- Follower/方芯: 8mm
- Distance/中心距: 72mm
- Backset/门距: 50/55/60mm

FDREND

- Type/类型: Round head/圆头 Square head/方头
- Thickness/厚度: 2.5mm 3.0mm
- Width/宽度: 24mm
- Finishes/表面处理: NB/AB/PB/SN/CP/GP

MATERIAL

- Latch bolt/斜舌: Brass/铜 Zinc Alloy/ 锌合金
- Dead bolt/方舌: Brass/铜 Zinc Alloy/ 锌合金 Steel/铁
- Forend/面板: Brass/铜 Stainless steel/ 不锈钢 Steel/铁

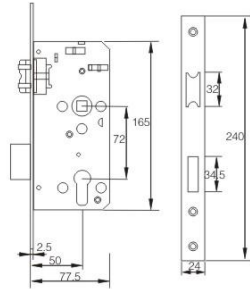

LOCK BODY SERIES



HX17-92-162

TECHNICAL DATA

- Follower/方芯: 8mm
- Distance/中心距: 85mm
- Backset/门距: 25mm

FDREND

- Type/类型: Round head/圆头 Square head/方头
- Thickness/厚度: 2.5mm 3.0mm
- Width/宽度: 22mm
- Finishes/表面处理: NB/AB/PB/SN/CP/GP

MATERIAL

- Latch bolt/斜舌: Brass/铜 Zinc Alloy/ 锌合金
- Dead bolt/方舌: Brass/铜 Zinc Alloy/ 锌合金 Steel/铁
- Forend/面板: Brass/铜 Stainless steel/ 不锈钢 Steel/铁

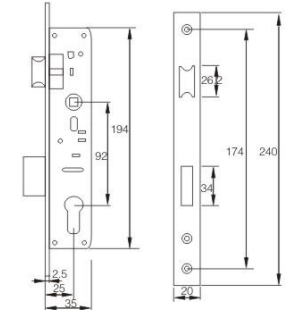

HX13-156

TECHNICAL DATA

- Follower/方芯: 8mm
- Distance/中心距: 85mm
- Backset/门距: 40/45/50/55/60mm

FDREND

- Type/类型: Round head/圆头 Square head/方头
- Thickness/厚度: 2.5mm 3.0mm
- Width/宽度: 23mm
- Finishes/表面处理: NB/AB/PB/SN/CP/GP

MATERIAL

- Latch bolt/斜舌: Brass/铜 Zinc Alloy/ 锌合金
- Dead bolt/方舌: Brass/铜 Zinc Alloy/ 锌合金 Steel/铁
- Forend/面板: Brass/铜 Stainless steel/ 不锈钢 Steel/铁

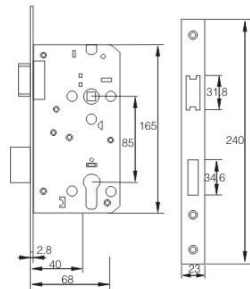

HX18-165

TECHNICAL DATA

- Follower/方芯: 8mm
- Distance/中心距: 85mm
- Backset/门距: 30mm

FDREND

- Type/类型: Round head/圆头 Square head/方头
- Thickness/厚度: 2.5mm 3.0mm
- Width/宽度: 22mm
- Finishes/表面处理: NB/AB/PB/SN/CP/GP

MATERIAL

- Latch bolt/斜舌: Brass/铜 Zinc Alloy/ 锌合金
- Dead bolt/方舌: Brass/铜 Zinc Alloy/ 锌合金 Steel/铁
- Forend/面板: Brass/铜 Stainless steel/ 不锈钢 Steel/铁

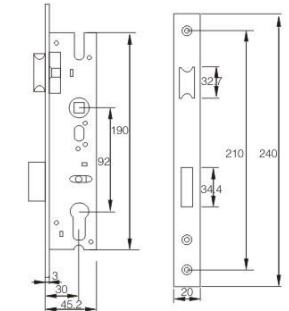

LOCK BODY SERIES



HX19-166

TECHNICAL DATA

- Follower/方芯: 8mm
- Distance/中心距: 92mm
- Backset/门距: 28mm

FDREND

- Type/类型: Round head/圆头 Square head/方头
- Thickness/厚度: 2.5mm 3.0mm
- Width/宽度: 22mm
- Finishes/表面处理: NB/AB/PB/SN/CP/GP

MATERIAL

- Latch bolt/斜舌: Brass/铜 Zinc Alloy/锌合金
- Dead bolt/方舌: Brass/铜 Zinc Alloy/锌合金 Steel/铁
- Forend/面板: Brass/铜 Stainless steel/不锈钢 Steel/铁

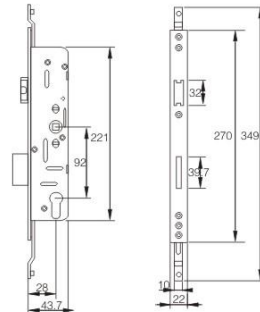

LOCK BODY SERIES



HX25-A-193

TECHNICAL DATA

- Follower/方芯: 8mm
- Distance/中心距: 无
- Backset/门距: 30mm

FDREND

- Type/类型: Round head/圆头 Square head/方头
- Thickness/厚度: 2.5mm 3.0mm
- Width/宽度: 23mm
- Finishes/表面处理: NB/AB/PB/SN/CP/GP

MATERIAL

- Latch bolt/斜舌: Brass/铜 Zinc Alloy/锌合金
- Dead bolt/方舌: Brass/铜 Zinc Alloy/锌合金 Steel/铁
- Forend/面板: Brass/铜 Stainless steel/不锈钢 Steel/铁

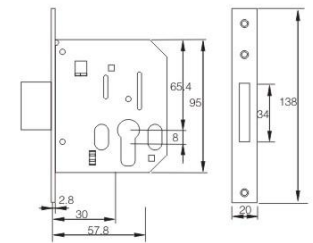

HX21-271

TECHNICAL DATA

- Follower/方芯: 8mm
- Distance/中心距: 75mm
- Backset/门距: 60mm

FDREND

- Type/类型: Round head/圆头 Square head/方头
- Thickness/厚度: 2.5mm 3.0mm
- Width/宽度: 22mm
- Finishes/表面处理: NB/AB/PB/SN/CP/GP

MATERIAL

- Latch bolt/斜舌: Brass/铜 Zinc Alloy/锌合金
- Dead bolt/方舌: Brass/铜 Zinc Alloy/锌合金 Steel/铁
- Forend/面板: Brass/铜 Stainless steel/不锈钢 Steel/铁

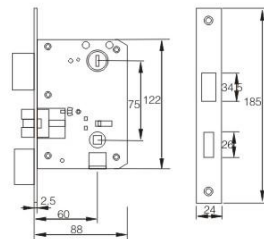

HX26-B-193

TECHNICAL DATA

- Follower/方芯: 8mm
- Distance/中心距: 无
- Backset/门距: 55mm

FDREND

- Type/类型: Round head/圆头 Square head/方头
- Thickness/厚度: 2.5mm 3.0mm
- Width/宽度: 23mm
- Finishes/表面处理: NB/AB/PB/SN/CP/GP

MATERIAL

- Latch bolt/斜舌: Brass/铜 Zinc Alloy/锌合金
- Dead bolt/方舌: Brass/铜 Zinc Alloy/锌合金 Steel/铁
- Forend/面板: Brass/铜 Stainless steel/不锈钢 Steel/铁

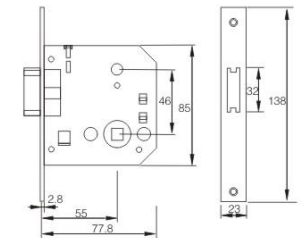

LOCK BODY SERIES



HT-9045-3M

TECHNICAL DATA

- Follower/方芯: 8mm
- Distance/中心距: 85mm
- Backset/门距: 45mm

FDREND

- Type/类型: Round head/圆头 Square head/方头
- Thickness/厚度: 2.5mm 3.0mm
- Width/宽度: 22mm
- Finishes/表面处理: NB/AB/PB/SN/CP/GP

MATERIAL

- Latch bolt/斜舌: Brass/铜 Zinc Alloy/ 锌合金
- Dead bolt/方舌: Steel/铁
- Forend/面板: Brass/铜 Stainless steel/ 不锈钢 Steel/铁

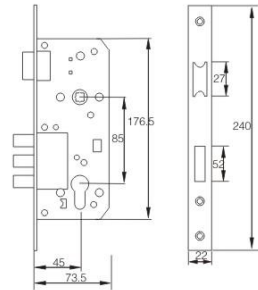

LOCK BODY SERIES



HT-252R

TECHNICAL DATA

- Follower/方芯: 8mm
- Distance/中心距: 85mm
- Backset/门距: 60mm

FDREND

- Type/类型: Round head/圆头 Square head/方头
- Thickness/厚度: 2.5mm 3.0mm
- Width/宽度: 22mm
- Finishes/表面处理: NB/AB/PB/SN/CP/GP

MATERIAL

- Latch bolt/斜舌: Steel/铁 Zinc Alloy/ 锌合金
- Dead bolt/方舌: Steel/铁
- Forend/面板: Brass/铜 Stainless steel/ 不锈钢 Steel/铁

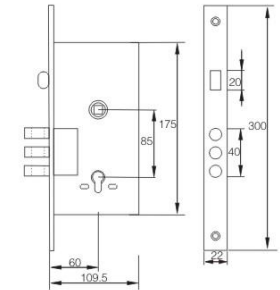

HT-9045A

TECHNICAL DATA

- Follower/方芯: 8mm
- Distance/中心距: 85mm
- Backset/门距: 45mm

FDREND

- Type/类型: Round head/圆头 Square head/方头
- Thickness/厚度: 2.5mm 3.0mm
- Width/宽度: 22mm
- Finishes/表面处理: NB/AB/PB/SN/CP/GP

MATERIAL

- Latch bolt/斜舌: Brass/铜 Zinc Alloy/ 锌合金
- Dead bolt/方舌: Brass/铜 Zinc Alloy/ 锌合金 Steel/铁
- Forend/面板: Brass/铜 Stainless steel/ 不锈钢 Steel/铁

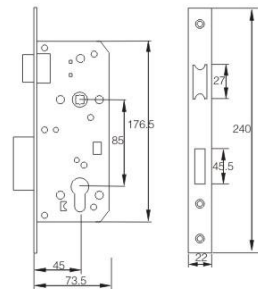

HT-257

TECHNICAL DATA

- Follower/方芯: 无
- Distance/中心距: 无
- Backset/门距: 60mm

FDREND

- Type/类型: Round head/圆头 Square head/方头
- Thickness/厚度: 2.5mm 3.0mm
- Width/宽度: 22mm
- Finishes/表面处理: NB/AB/PB/SN/CP/GP

MATERIAL

- Latch bolt/斜舌: Steel/铁
- Dead bolt/方舌: Steel/铁
- Forend/面板: Brass/铜 Stainless steel/ 不锈钢 Steel/铁

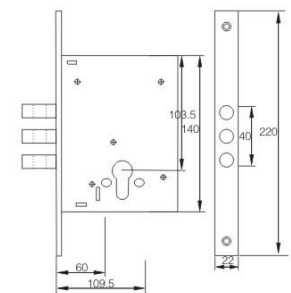

LOCK BODY SERIES



HT-1251

TECHNICAL DATA

- Follower/方芯: 8mm
- Distance/中心距: 61.5mm
- Backset/门距: 45mm

FDREND

- Type/类型: Round head/圆头 Square head/方头
- Thickness/厚度: 2.5mm 3.0mm
- Width/宽度: 22mm
- Finishes/表面处理: NB/AB/PB/SN/CP/GP

MATERIAL

- Latch bolt/斜舌: Brass/铜 Zinc Alloy/ 锌合金
- Dead bolt/方舌: Brass/铜 Zinc Alloy/ 锌合金 Steel/铁
- Forend/面板: Brass/铜 Stainless steel/ 不锈钢 Steel/铁

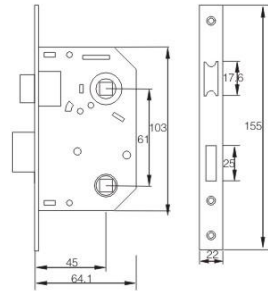

LOCK BODY SERIES



HT-9036B

TECHNICAL DATA

- Follower/方芯: 8mm
- Distance/中心距: 61.5mm
- Backset/门距: 40mm

FDREND

- Type/类型: Round head/圆头 Square head/方头
- Thickness/厚度: 2.5mm 3.0mm
- Width/宽度: 22mm
- Finishes/表面处理: NB/AB/PB/SN/CP/GP

MATERIAL

- Latch bolt/斜舌: Brass/铜 Zinc Alloy/ 锌合金
- Dead bolt/方舌: Brass/铜 Zinc Alloy/ 锌合金 Steel/铁
- Forend/面板: Brass/铜 Stainless steel/ 不锈钢 Steel/铁

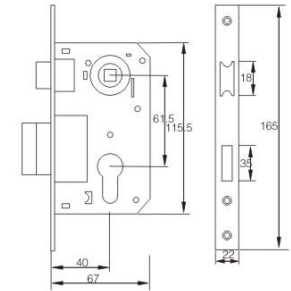

HT-751/752

TECHNICAL DATA

- Follower/方芯: 8mm
- Distance/中心距: 61.5mm
- Backset/门距: 45mm

FDREND

- Type/类型: Round head/圆头 Square head/方头
- Thickness/厚度: 2.5mm 3.0mm
- Width/宽度: 22mm
- Finishes/表面处理: NB/AB/PB/SN/CP/GP

MATERIAL

- Latch bolt/斜舌: Brass/铜 Zinc Alloy/ 锌合金
- Dead bolt/方舌: Brass/铜 Zinc Alloy/ 锌合金 Steel/铁
- Forend/面板: Brass/铜 Stainless steel/ 不锈钢 Steel/铁

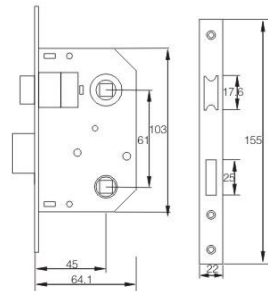

HT-9036

TECHNICAL DATA

- Follower/方芯: 8mm
- Distance/中心距: 61.5mm
- Backset/门距: 40mm

FDREND

- Type/类型: Round head/圆头 Square head/方头
- Thickness/厚度: 2.5mm 3.0mm
- Width/宽度: 22mm
- Finishes/表面处理: NB/AB/PB/SN/CP/GP

MATERIAL

- Latch bolt/斜舌: Brass/铜 Zinc Alloy/ 锌合金
- Dead bolt/方舌: Brass/铜 Zinc Alloy/ 锌合金 Steel/铁
- Forend/面板: Brass/铜 Stainless steel/ 不锈钢 Steel/铁

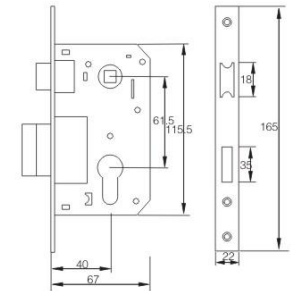

LOCK BODY SERIES



TECHNICAL DATA

- Follower/方芯: 8mm
- Distance/中心距: 61.5mm
- Backset/门距: 40mm

FDREND

- Type/类型: Round head/圆头 Square head/方头
- Thickness/厚度: 2.5mm 3.0mm
- Width/宽度: 22mm
- Finishes/表面处理: NB/AB/PB/SN/CP/GP

MATERIAL

- Latch bolt/斜舌: Brass/铜
- Dead bolt/方舌: Steel/铁
- Forend/面板: Brass/铜 Stainless steel/不锈钢 Steel/铁

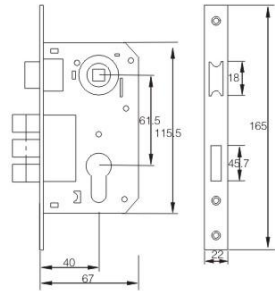

HT-9036B-3R

LOCK BODY SERIES



TECHNICAL DATA

- Follower/方芯: 8mm
- Distance/中心距: 55mm
- Backset/门距: 55mm

FDREND

- Type/类型: Round head/圆头 Square head/方头
- Thickness/厚度: 2.5mm 3.0mm
- Width/宽度: 22mm
- Finishes/表面处理: NB/AB/PB/SN/CP/GP

MATERIAL

- Latch bolt/斜舌: Brass/铜 Zinc Alloy/锌合金
- Dead bolt/方舌: Brass/铜 Zinc Alloy/锌合金 Steel/铁
- Forend/面板: Brass/铜 Stainless steel/不锈钢 Steel/铁

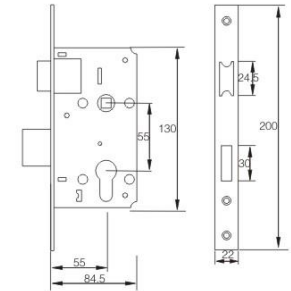

HT-968-55



TECHNICAL DATA

- Follower/方芯: 8mm
- Distance/中心距: 55mm
- Backset/门距: 45mm

FDREND

- Type/类型: Round head/圆头 Square head/方头
- Thickness/厚度: 2.5mm 3.0mm
- Width/宽度: 22mm
- Finishes/表面处理: NB/AB/PB/SN/CP/GP

MATERIAL

- Latch bolt/斜舌: Brass/铜 Zinc Alloy/锌合金
- Dead bolt/方舌: Brass/铜 Zinc Alloy/锌合金 Steel/铁
- Forend/面板: Brass/铜 Stainless steel/不锈钢 Steel/铁

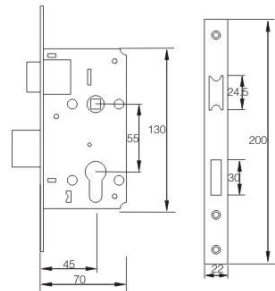

HT-968-45



TECHNICAL DATA

- Follower/方芯: 8mm
- Distance/中心距: 62mm
- Backset/门距: 40mm

FDREND

- Type/类型: Round head/圆头 Square head/方头
- Thickness/厚度: 2.5mm 3.0mm
- Width/宽度: 22mm
- Finishes/表面处理: NB/AB/PB/SN/CP/GP

MATERIAL

- Latch bolt/斜舌: Brass/铜 Zinc Alloy/锌合金
- Dead bolt/方舌: Brass/铜 Zinc Alloy/锌合金 Steel/铁
- Forend/面板: Brass/铜 Stainless steel/不锈钢 Steel/铁

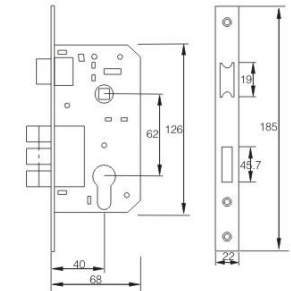

HT-6240-3M

LOCK BODY SERIES



TECHNICAL DATA

- Follower/方芯: 8mm
- Distance/中心距: 70mm
- Backset/门距: 40/45/50mm

FDREND

- Type/类型: Round head/圆头 Square head/方头
- Thickness/厚度: 2.5mm 3.0mm
- Width/宽度: 22mm
- Finishes/表面处理: NB/AB/PB/SN/CP/GP

MATERIAL

- Latch bolt/斜舌: Brass/铜 Zinc Alloy/ 锌合金
- Dead bolt/方舌: Brass/铜 Zinc Alloy/ 锌合金 Steel/铁
- Forend/面板: Brass/铜 Stainless steel/ 不锈钢 Steel/铁

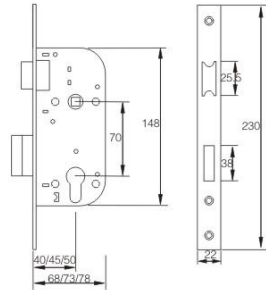

HT-7025-40/45/50

LOCK BODY SERIES



TECHNICAL DATA

- Follower/方芯: 8mm
- Distance/中心距: 85mm
- Backset/门距: 40mm

FDREND

- Type/类型: Round head/圆头 Square head/方头
- Thickness/厚度: 2.5mm 3.0mm
- Width/宽度: 22mm
- Finishes/表面处理: NB/AB/PB/SN/CP/GP

MATERIAL

- Latch bolt/斜舌: Brass/铜 Zinc Alloy/ 锌合金
- Dead bolt/方舌: Brass/铜 Zinc Alloy/ 锌合金 Steel/铁
- Forend/面板: Brass/铜 Stainless steel/ 不锈钢 Steel/铁

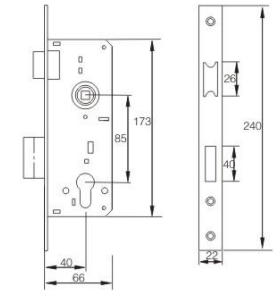

HT-152R-40



TECHNICAL DATA

- Follower/方芯: 8mm
- Distance/中心距: 70mm
- Backset/门距: 40/45mm

FDREND

- Type/类型: Round head/圆头 Square head/方头
- Thickness/厚度: 2.5mm 3.0mm
- Width/宽度: 22mm
- Finishes/表面处理: NB/AB/PB/SN/CP/GP

MATERIAL

- Latch bolt/斜舌: Steel/铁 Zinc Alloy/ 锌合金
- Dead bolt/方舌: Steel/铁
- Forend/面板: Brass/铜 Stainless steel/ 不锈钢 Steel/铁

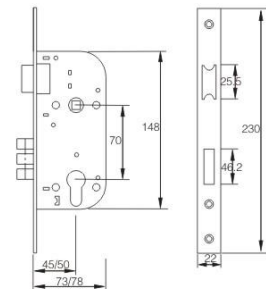

HT-7025-40/50-3R



TECHNICAL DATA

- Follower/方芯: 8mm
- Distance/中心距: 85mm
- Backset/门距: 45mm

FDREND

- Type/类型: Round head/圆头 Square head/方头
- Thickness/厚度: 2.5mm 3.0mm
- Width/宽度: 22mm
- Finishes/表面处理: NB/AB/PB/SN/CP/GP

MATERIAL

- Latch bolt/斜舌: Brass/铜 Zinc Alloy/ 锌合金
- Dead bolt/方舌: Brass/铜 Zinc Alloy/ 锌合金 Steel/铁
- Forend/面板: Brass/铜 Stainless steel/ 不锈钢 Steel/铁

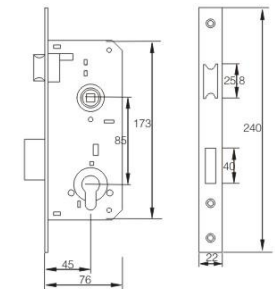

HT-150-45R

LOCK BODY SERIES



TECHNICAL DATA

- Follower/方芯: 8mm
- Distance/中心距: 47mm
- Backset/门距: 50mm

FDREND

- Type/类型: Round head/圆头 Square head/方头
- Thickness/厚度: 2.5mm 3.0mm
- Width/宽度: 22mm
- Finishes/表面处理: NB/AB/PB/SN/CP/GP

MATERIAL

- Latch bolt/斜舌: Brass/铜 Zinc Alloy/锌合金
- Dead bolt/方舌: Brass/铜 Zinc Alloy/锌合金 Steel/铁
- Forend/面板: Brass/铜 Stainless steel/不锈钢 Steel/铁

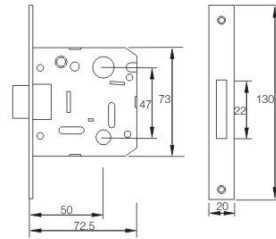

HT-5047D

LOCK BODY SERIES



TECHNICAL DATA

- Follower/方芯: 8mm
- Distance/中心距: 85mm
- Backset/门距: 35mm

FDREND

- Type/类型: Round head/圆头 Square head/方头
- Thickness/厚度: 2.5mm 3.0mm
- Width/宽度: 22mm
- Finishes/表面处理: NB/AB/PB/SN/CP/GP

MATERIAL

- Latch bolt/斜舌: Brass/铜 Zinc Alloy/锌合金
- Dead bolt/方舌: Brass/铜 Zinc Alloy/锌合金 Steel/铁
- Forend/面板: Brass/铜 Stainless steel/不锈钢 Steel/铁

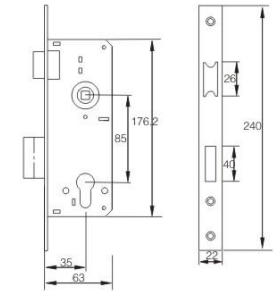

HT-510.35-R



TECHNICAL DATA

- Follower/方芯: 8mm
- Distance/中心距: 70mm
- Backset/门距: 50mm

FDREND

- Type/类型: Round head/圆头 Square head/方头
- Thickness/厚度: 2.5mm 3.0mm
- Width/宽度: 22mm
- Finishes/表面处理: NB/AB/PB/SN/CP/GP

MATERIAL

- Latch bolt/斜舌: Brass/铜 Zinc Alloy/锌合金
- Dead bolt/方舌: Brass/铜 Zinc Alloy/锌合金 Steel/铁
- Forend/面板: Brass/铜 Stainless steel/不锈钢 Steel/铁

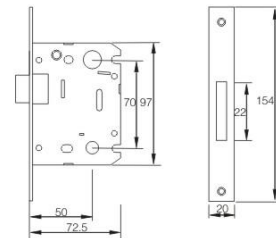

HT-7050D



TECHNICAL DATA

- Follower/方芯: 8mm
- Distance/中心距: 85mm
- Backset/门距: 40mm

FDREND

- Type/类型: Round head/圆头 Square head/方头
- Thickness/厚度: 2.5mm 3.0mm
- Width/宽度: 22mm
- Finishes/表面处理: NB/AB/PB/SN/CP/GP

MATERIAL

- Latch bolt/斜舌: Brass/铜 Zinc Alloy/锌合金
- Dead bolt/方舌: Brass/铜 Zinc Alloy/锌合金 Steel/铁
- Forend/面板: Brass/铜 Stainless steel/不锈钢 Steel/铁

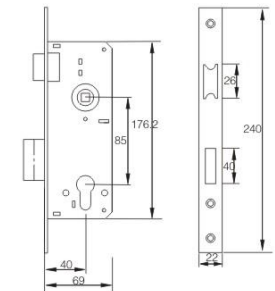

HT-510.40-R

LOCK BODY SERIES



HT-510.45-R

TECHNICAL DATA

- Follower/方芯: 8mm
- Distance/中心距: 85mm
- Backset/门距: 45mm

FDREND

- Type/类型: Round head/圆头 Square head/方头
- Thickness/厚度: 2.5mm 3.0mm
- Width/宽度: 22mm
- Finishes/表面处理: NB/AB/PB/SN/CP/GP

MATERIAL

- Latch bolt/斜舌: Brass/铜 Zinc Alloy/ 锌合金
- Dead bolt/方舌: Brass/铜 Zinc Alloy/ 锌合金 Steel/铁
- Forend/面板: Brass/铜 Stainless steel/ 不锈钢 Steel/铁

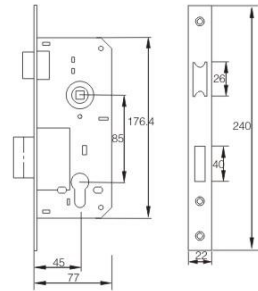

LOCK BODY SERIES



HT-154R-45

TECHNICAL DATA

- Follower/方芯: 8mm
- Distance/中心距: 85mm
- Backset/门距: 45mm

FDREND

- Type/类型: Round head/圆头 Square head/方头
- Thickness/厚度: 2.5mm 3.0mm
- Width/宽度: 22mm
- Finishes/表面处理: NB/AB/PB/SN/CP/GP

MATERIAL

- Latch bolt/斜舌: Brass/铜 Zinc Alloy/ 锌合金
- Dead bolt/方舌: Steel/铁
- Forend/面板: Brass/铜 Stainless steel/ 不锈钢 Steel/铁

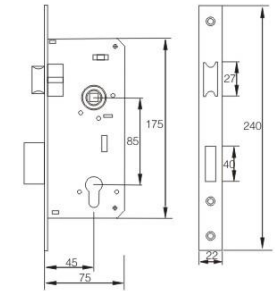

HT-510.45-R3M

TECHNICAL DATA

- Follower/方芯: 8mm
- Distance/中心距: 85mm
- Backset/门距: 45mm

FDREND

- Type/类型: Round head/圆头 Square head/方头
- Thickness/厚度: 2.5mm 3.0mm
- Width/宽度: 22mm
- Finishes/表面处理: NB/AB/PB/SN/CP/GP

MATERIAL

- Latch bolt/斜舌: Steel/铁 Zinc Alloy/ 锌合金
- Dead bolt/方舌: Steel/铁
- Forend/面板: Brass/铜 Stainless steel/ 不锈钢 Steel/铁

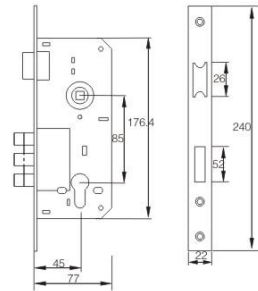

HT-154R-45-3M

TECHNICAL DATA

- Follower/方芯: 8mm
- Distance/中心距: 85mm
- Backset/门距: 45mm

FDREND

- Type/类型: Round head/圆头 Square head/方头
- Thickness/厚度: 2.5mm 3.0mm
- Width/宽度: 22mm
- Finishes/表面处理: NB/AB/PB/SN/CP/GP

MATERIAL

- Latch bolt/斜舌: Brass/铜 Zinc Alloy/ 锌合金
- Dead bolt/方舌: Brass/铜 Zinc Alloy/ 锌合金 Steel/铁
- Forend/面板: Brass/铜 Stainless steel/ 不锈钢 Steel/铁

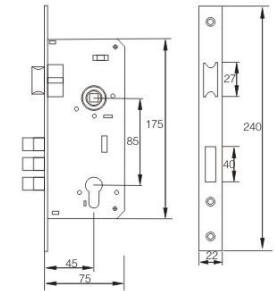

LOCK BODY SERIES



HT-152-45

TECHNICAL DATA

- Follower/方芯: 8mm
- Distance/中心距: 85mm
- Backset/门距: 45mm

FDREND

- Type/类型: Round head/圆头 Square head/方头
- Thickness/厚度: 2.5mm 3.0mm
- Width/宽度: 22mm
- Finishes/表面处理: NB/AB/PB/SN/CP/GP

MATERIAL

- Latch bolt/斜舌: Brass/铜 Zinc Alloy/锌合金
- Dead bolt/方舌: Brass/铜 Zinc Alloy/锌合金 Steel/铁
- Forend/面板: Brass/铜 Stainless steel/不锈钢 Steel/铁

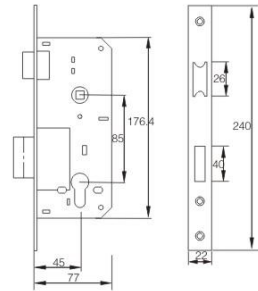

LOCK BODY SERIES



HT-153P-20/25/30/35

TECHNICAL DATA

- Follower/方芯: 8mm
- Distance/中心距: 85mm
- Backset/门距: 20/25/30/35mm

FDREND

- Type/类型: Round head/圆头 Square head/方头
- Thickness/厚度: 2.5mm 3.0mm
- Width/宽度: 22mm
- Finishes/表面处理: NB/AB/PB/SN/CP/GP

MATERIAL

- Latch bolt/斜舌: Brass/铜 Zinc Alloy/锌合金
- Dead bolt/方舌: Brass/铜 Zinc Alloy/锌合金 Steel/铁
- Forend/面板: Brass/铜 Stainless steel/不锈钢 Steel/铁

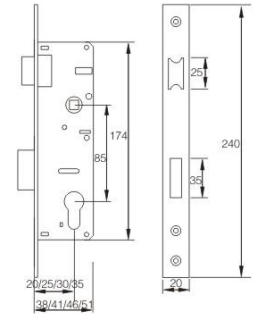

HT-510.60-R

TECHNICAL DATA

- Follower/方芯: 8mm
- Distance/中心距: 85mm
- Backset/门距: 60mm

FDREND

- Type/类型: Round head/圆头 Square head/方头
- Thickness/厚度: 2.5mm 3.0mm
- Width/宽度: 22mm
- Finishes/表面处理: NB/AB/PB/SN/CP/GP

MATERIAL

- Latch bolt/斜舌: Brass/铜 Zinc Alloy/锌合金
- Dead bolt/方舌: Brass/铜 Zinc Alloy/锌合金 Steel/铁
- Forend/面板: Brass/铜 Stainless steel/不锈钢 Steel/铁

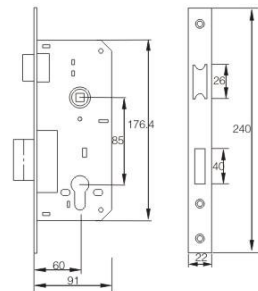

HT-269PWC-20/25/30/35

TECHNICAL DATA

- Follower/方芯: 8mm
- Distance/中心距: 90mm
- Backset/门距: 20/25/30/35mm

FDREND

- Type/类型: Round head/圆头 Square head/方头
- Thickness/厚度: 2.5mm 3.0mm
- Width/宽度: 22mm
- Finishes/表面处理: NB/AB/PB/SN/CP/GP

MATERIAL

- Latch bolt/斜舌: Brass/铜 Zinc Alloy/锌合金
- Dead bolt/方舌: Brass/铜 Zinc Alloy/锌合金 Steel/铁
- Forend/面板: Brass/铜 Stainless steel/不锈钢 Steel/铁

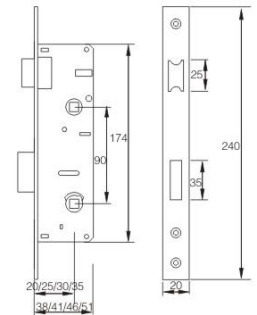

LOCK BODY SERIES



HT-155U-20/25/30/35

TECHNICAL DATA

- Follower/方芯: 无
- Distance/中心距: 85mm
- Backset/门距: 20/25/30/35mm

FDREND

- Type/类型: Round head/圆头 Square head/方头
- Thickness/厚度: 2.5mm 3.0mm
- Width/宽度: 22mm
- Finishes/表面处理: NB/AB/PB/SN/CP/GP

MATERIAL

- Latch bolt/斜舌: Brass/铜 Zinc Alloy/锌合金
- Dead bolt/方舌: Brass/铜 Zinc Alloy/锌合金 Steel/铁
- Forend/面板: Brass/铜 Stainless steel/不锈钢 Steel/铁

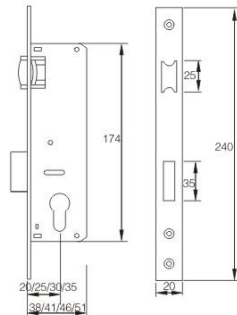

LOCK BODY SERIES



HT-269PLW-20/25/30/35

TECHNICAL DATA

- Follower/方芯: 8mm
- Distance/中心距: 85mm
- Backset/门距: 20/25/30/35mm

FDREND

- Type/类型: Round head/圆头 Square head/方头
- Thickness/厚度: 2.5mm 3.0mm
- Width/宽度: 22mm
- Finishes/表面处理: NB/AB/PB/SN/CP/GP

MATERIAL

- Latch bolt/斜舌: Brass/铜 Zinc Alloy/锌合金
- Dead bolt/方舌: Brass/铜 Zinc Alloy/锌合金 Steel/铁
- Forend/面板: Brass/铜 Stainless steel/不锈钢 Steel/铁

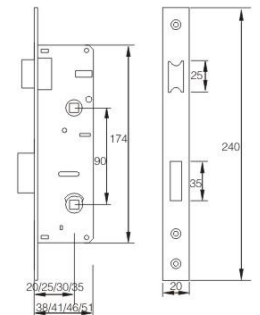

HT-155UL-20/25/30/35

TECHNICAL DATA

- Follower/方芯: 8mm
- Distance/中心距: 85mm
- Backset/门距: 20/25/30/35mm

FDREND

- Type/类型: Round head/圆头 Square head/方头
- Thickness/厚度: 2.5mm 3.0mm
- Width/宽度: 22mm
- Finishes/表面处理: NB/AB/PB/SN/CP/GP

MATERIAL

- Latch bolt/斜舌: Brass/铜 Zinc Alloy/锌合金
- Dead bolt/方舌: Brass/铜 Zinc Alloy/锌合金 Steel/铁
- Forend/面板: Brass/铜 Stainless steel/不锈钢 Steel/铁

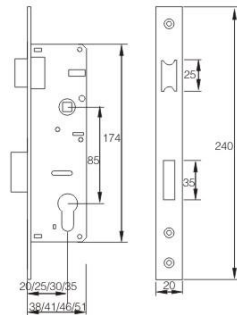

HT-8515

TECHNICAL DATA

- Follower/方芯: 8mm
- Distance/中心距: 85mm
- Backset/门距: 15mm

FDREND

- Type/类型: Round head/圆头 Square head/方头
- Thickness/厚度: 2.5mm 3.0mm
- Width/宽度: 22mm
- Finishes/表面处理: NB/AB/PB/SN/CP/GP

MATERIAL

- Latch bolt/斜舌: Brass/铜 Zinc Alloy/锌合金
- Dead bolt/方舌: Brass/铜 Zinc Alloy/锌合金 Steel/铁
- Forend/面板: Brass/铜 Stainless steel/不锈钢 Steel/铁

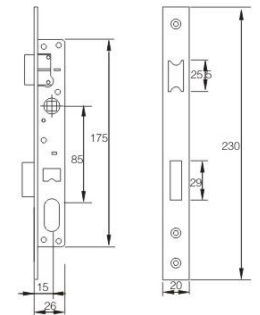

LOCK BODY SERIES



HT-724BB

TECHNICAL DATA

- Follower/方芯: 8mm
- Distance/中心距: 90mm
- Backset/门距: 35mm

FDREND

- Type/类型: Round head/圆头 Square head/方头
- Thickness/厚度: 2.5mm 3.0mm
- Width/宽度: 22mm
- Finishes/表面处理: NB/AB/PB/SN/CP/GP

MATERIAL

- Latch bolt/斜舌: Brass/铜 Zinc Alloy/锌合金
- Dead bolt/方舌: Brass/铜 Zinc Alloy/锌合金 Steel/铁
- Forend/面板: Brass/铜 Stainless steel/不锈钢 Steel/铁

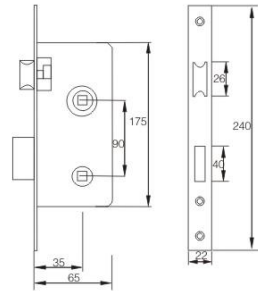

LOCK BODY SERIES



HT-7050

TECHNICAL DATA

- Follower/方芯: 8mm
- Distance/中心距: 70mm
- Backset/门距: 50mm

FDREND

- Type/类型: Round head/圆头 Square head/方头
- Thickness/厚度: 2.5mm 3.0mm
- Width/宽度: 22mm
- Finishes/表面处理: NB/AB/PB/SN/CP/GP

MATERIAL

- Latch bolt/斜舌: Brass/铜 Zinc Alloy/锌合金
- Dead bolt/方舌: Brass/铜 Zinc Alloy/锌合金 Steel/铁
- Forend/面板: Brass/铜 Stainless steel/不锈钢 Steel/铁

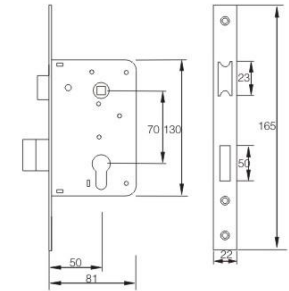

HT-7240BK

TECHNICAL DATA

- Follower/方芯: 8mm
- Distance/中心距: 90mm
- Backset/门距: 40mm

FDREND

- Type/类型: Round head/圆头 Square head/方头
- Thickness/厚度: 2.5mm 3.0mm
- Width/宽度: 22mm
- Finishes/表面处理: NB/AB/PB/SN/CP/GP

MATERIAL

- Latch bolt/斜舌: Brass/铜 Zinc Alloy/锌合金
- Dead bolt/方舌: Brass/铜 Zinc Alloy/锌合金 Steel/铁
- Forend/面板: Brass/铜 Stainless steel/不锈钢 Steel/铁

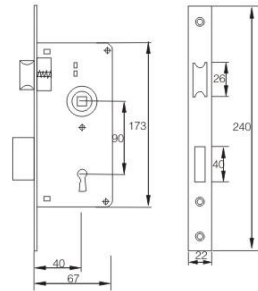

HT-5745

TECHNICAL DATA

- Follower/方芯: 8mm
- Distance/中心距: 57mm
- Backset/门距: 45mm

FDREND

- Type/类型: Round head/圆头 Square head/方头
- Thickness/厚度: 2.5mm 3.0mm
- Width/宽度: 22mm
- Finishes/表面处理: NB/AB/PB/SN/CP/GP

MATERIAL

- Latch bolt/斜舌: Brass/铜 Zinc Alloy/锌合金
- Dead bolt/方舌: Brass/铜 Zinc Alloy/锌合金 Steel/铁
- Forend/面板: Brass/铜 Stainless steel/不锈钢 Steel/铁

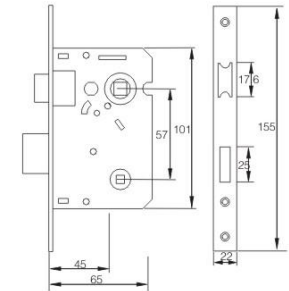

LOCK BODY SERIES



TECHNICAL DATA

- Follower/方芯: 8mm
- Distance/中心距: 57mm
- Backset/门距: 57mm

FDREND

- Type/类型: Round head/圆头 Square head/方头
- Thickness/厚度: 2.5mm 3.0mm
- Width/宽度: 22mm
- Finishes/表面处理: NB/AB/PB/SN/CP/GP

MATERIAL

- Latch bolt/斜舌: Brass/铜 Zinc Alloy/锌合金
- Dead bolt/方舌: Brass/铜 Zinc Alloy/锌合金 Steel/铁
- Forend/面板: Brass/铜 Stainless steel/不锈钢 Steel/铁

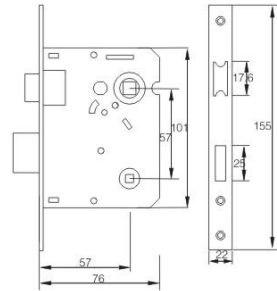

HT-5757

LOCK BODY SERIES



TECHNICAL DATA

- Follower/方芯: 8mm
- Distance/中心距: 85mm
- Backset/门距: 45mm

FDREND

- Type/类型: Round head/圆头 Square head/方头
- Thickness/厚度: 2.5mm 3.0mm
- Width/宽度: 22mm
- Finishes/表面处理: NB/AB/PB/SN/CP/GP

MATERIAL

- Latch bolt/斜舌: Brass/铜 Zinc Alloy/锌合金
- Dead bolt/方舌: Brass/铜 Zinc Alloy/锌合金 Steel/铁
- Forend/面板: Brass/铜 Stainless steel/不锈钢 Steel/铁

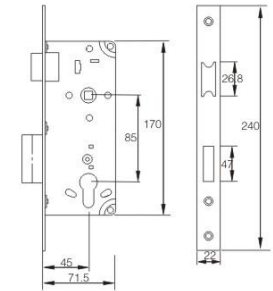

HT-9025-45



TECHNICAL DATA

- Follower/方芯: 8mm
- Distance/中心距: 无
- Backset/门距: 28mm

FDREND

- Type/类型: Round head/圆头 Square head/方头
- Thickness/厚度: 2.5mm 3.0mm
- Width/宽度: 22mm
- Finishes/表面处理: NB/AB/PB/SN/CP/GP

MATERIAL

- Latch bolt/斜舌: Brass/铜 Zinc Alloy/锌合金
- Dead bolt/方舌: Brass/铜 Zinc Alloy/锌合金 Steel/铁
- Forend/面板: Brass/铜 Stainless steel/不锈钢 Steel/铁

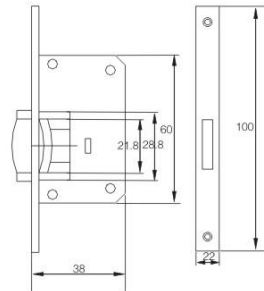

HT-200



TECHNICAL DATA

- Follower/方芯: 8mm
- Distance/中心距: 85mm
- Backset/门距: 40mm

FDREND

- Type/类型: Round head/圆头 Square head/方头
- Thickness/厚度: 2.5mm 3.0mm
- Width/宽度: 22mm
- Finishes/表面处理: NB/AB/PB/SN/CP/GP

MATERIAL

- Latch bolt/斜舌: Brass/铜 Zinc Alloy/锌合金
- Dead bolt/方舌: Brass/铜 Zinc Alloy/锌合金 Steel/铁
- Forend/面板: Brass/铜 Stainless steel/不锈钢 Steel/铁

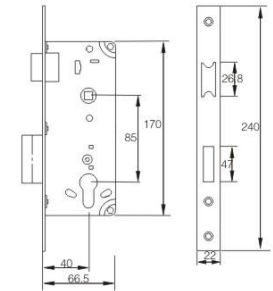

HT-9025-40

LOCK BODY SERIES



HT-118C

TECHNICAL DATA

- Follower/方芯: 8mm
- Distance/中心距: 无
- Backset/门距: 20mm

FDREND

- Type/类型: Round head/圆头 Square head/方头
- Thickness/厚度: 2.5mm 3.0mm
- Width/宽度: 22mm
- Finishes/表面处理: NB/AB/PB/SN/CP/GP

MATERIAL

- Latch bolt/斜舌: Brass/铜 Zinc Alloy/锌合金
- Dead bolt/方舌: Brass/铜 Zinc Alloy/锌合金 Steel/铁
- Forend/面板: Brass/铜 Stainless steel/不锈钢 Steel/铁

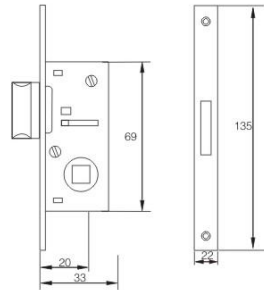

LOCK BODY SERIES



HT-4800

TECHNICAL DATA

- Follower/方芯: 8mm
- Distance/中心距: 53mm
- Backset/门距: 40mm

FDREND

- Type/类型: Round head/圆头 Square head/方头
- Thickness/厚度: 2.5mm 3.0mm
- Width/宽度: 22mm
- Finishes/表面处理: NB/AB/PB/SN/CP/GP

MATERIAL

- Latch bolt/斜舌: Brass/铜 Zinc Alloy/锌合金
- Dead bolt/方舌: Brass/铜 Zinc Alloy/锌合金 Steel/铁
- Forend/面板: Brass/铜 Stainless steel/不锈钢 Steel/铁

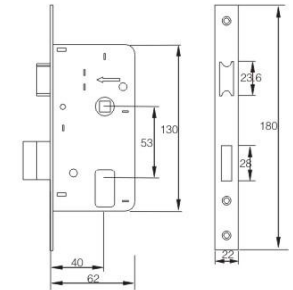

HT-8100

TECHNICAL DATA

- Follower/方芯: 无
- Distance/中心距: 无
- Backset/门距: 65mm

FDREND

- Type/类型: Round head/圆头 Square head/方头
- Thickness/厚度: 2.5mm 3.0mm
- Width/宽度: 22mm
- Finishes/表面处理: NB/AB/PB/SN/CP/GP

MATERIAL

- Latch bolt/斜舌: Brass/铜 Zinc Alloy/锌合金
- Dead bolt/方舌: Brass/铜 Zinc Alloy/锌合金 Steel/铁
- Forend/面板: Brass/铜 Stainless steel/不锈钢 Steel/铁

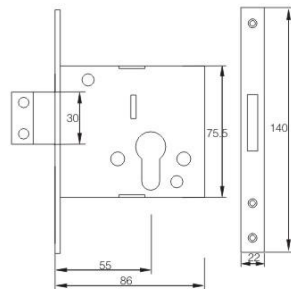

HT-9235S

TECHNICAL DATA

- Follower/方芯: 8mm
- Distance/中心距: 92mm
- Backset/门距: 34mm

FDREND

- Type/类型: Round head/圆头 Square head/方头
- Thickness/厚度: 2.5mm 3.0mm
- Width/宽度: 22mm
- Finishes/表面处理: NB/AB/PB/SN/CP/GP

MATERIAL

- Latch bolt/斜舌: Brass/铜 Zinc Alloy/锌合金
- Dead bolt/方舌: Brass/铜 Zinc Alloy/锌合金 Steel/铁
- Forend/面板: Brass/铜 Stainless steel/不锈钢 Steel/铁

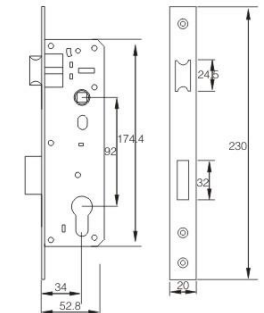

LOCK BODY SERIES



TECHNICAL DATA

- Follower/方芯: 无
- Distance/中心距: 无
- Backset/门距: 51mm

FDREND

- Type/类型: Round head/圆头 Square head/方头
- Thickness/厚度: 2.5mm 3.0mm
- Width/宽度: 22mm
- Finishes/表面处理: NB/AB/PB/SN/CP/GP

MATERIAL

- Latch bolt/斜舌: Steel/铁
- Dead bolt/方舌: Steel/铁
- Forend/面板: Brass/铜 Stainless steel/不锈钢 Steel/铁

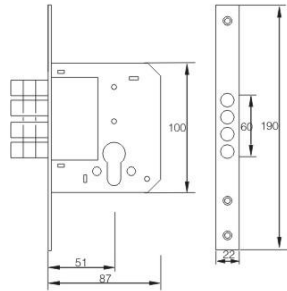

HT-189-4M

LOCK BODY SERIES



TECHNICAL DATA

- Follower/方芯: 无
- Distance/中心距: 无
- Backset/门距: 45mm

FDREND

- Type/类型: Round head/圆头 Square head/方头
- Thickness/厚度: 2.5mm 3.0mm
- Width/宽度: 22mm
- Finishes/表面处理: NB/AB/PB/SN/CP/GP

MATERIAL

- Latch bolt/斜舌: Brass/铜 Zinc Alloy/锌合金
- Dead bolt/方舌: Brass/铜 Zinc Alloy/锌合金 Steel/铁
- Forend/面板: Brass/铜 Stainless steel/不锈钢 Steel/铁

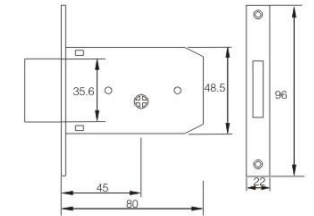

HT-900



TECHNICAL DATA

- Follower/方芯: 无
- Distance/中心距: 无
- Backset/门距: 51mm

FDREND

- Type/类型: Round head/圆头 Square head/方头
- Thickness/厚度: 2.5mm 3.0mm
- Width/宽度: 22mm
- Finishes/表面处理: NB/AB/PB/SN/CP/GP

MATERIAL

- Latch bolt/斜舌: Steel/铁
- Dead bolt/方舌: Steel/铁
- Forend/面板: Brass/铜 Stainless steel/不锈钢 Steel/铁

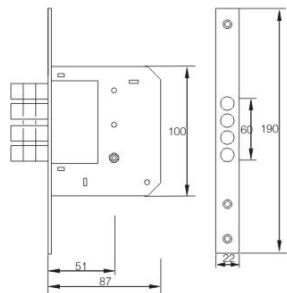

HT-189-4MF



TECHNICAL DATA

- Follower/方芯: 8mm
- Distance/中心距: 70mm
- Backset/门距: 40mm

FDREND

- Type/类型: Round head/圆头 Square head/方头
- Thickness/厚度: 2.5mm 3.0mm
- Width/宽度: 22mm
- Finishes/表面处理: NB/AB/PB/SN/CP/GP

MATERIAL

- Latch bolt/斜舌: Brass/铜 Zinc Alloy/锌合金
- Dead bolt/方舌: Brass/铜 Zinc Alloy/锌合金 Steel/铁
- Forend/面板: Brass/铜 Stainless steel/不锈钢 Steel/铁

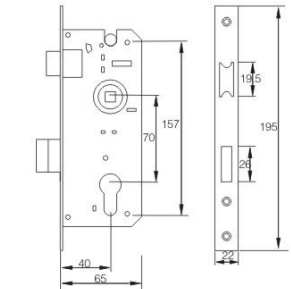

HT-7040B

LOCK BODY SERIES



HT-9235SWC

TECHNICAL DATA

- Follower/方芯: 8mm
- Distance/中心距: 92mm
- Backset/门距: 34mm

FDREND

- Type/类型: Round head/圆头 Square head/方头
- Thickness/厚度: 2.5mm 3.0mm
- Width/宽度: 22mm
- Finishes/表面处理: NB/AB/PB/SN/CP/GP

MATERIAL

- Latch bolt/斜舌: Brass/铜 Zinc Alloy/锌合金
- Dead bolt/方舌: Brass/铜 Zinc Alloy/锌合金 Steel/铁
- Forend/面板: Brass/铜 Stainless steel/不锈钢 Steel/铁

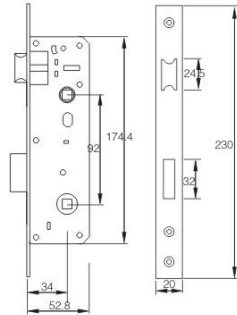

LOCK BODY SERIES



HT-9220S

TECHNICAL DATA

- Follower/方芯: 8mm
- Distance/中心距: 92mm
- Backset/门距: 20mm

FDREND

- Type/类型: Round head/圆头 Square head/方头
- Thickness/厚度: 2.5mm 3.0mm
- Width/宽度: 22mm
- Finishes/表面处理: NB/AB/PB/SN/CP/GP

MATERIAL

- Latch bolt/斜舌: Brass/铜 Zinc Alloy/锌合金
- Dead bolt/方舌: Brass/铜 Zinc Alloy/锌合金 Steel/铁
- Forend/面板: Brass/铜 Stainless steel/不锈钢 Steel/铁

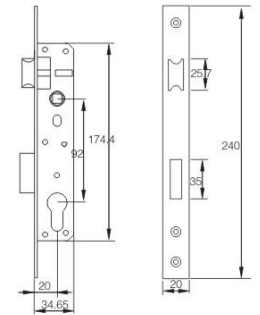

HT-9235S

TECHNICAL DATA

- Follower/方芯: 8mm
- Distance/中心距: 92mm
- Backset/门距: 34mm

FDREND

- Type/类型: Round head/圆头 Square head/方头
- Thickness/厚度: 2.5mm 3.0mm
- Width/宽度: 22mm
- Finishes/表面处理: NB/AB/PB/SN/CP/GP

MATERIAL

- Latch bolt/斜舌: Brass/铜 Zinc Alloy/锌合金
- Dead bolt/方舌: Brass/铜 Zinc Alloy/锌合金 Steel/铁
- Forend/面板: Brass/铜 Stainless steel/不锈钢 Steel/铁

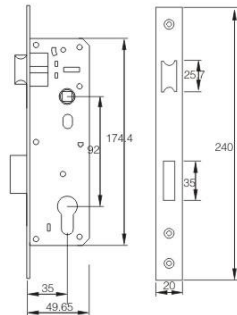

HT-8535S

TECHNICAL DATA

- Follower/方芯: 8mm
- Distance/中心距: 92mm
- Backset/门距: 25mm

FDREND

- Type/类型: Round head/圆头 Square head/方头
- Thickness/厚度: 2.5mm 3.0mm
- Width/宽度: 22mm
- Finishes/表面处理: NB/AB/PB/SN/CP/GP

MATERIAL

- Latch bolt/斜舌: Brass/铜 Zinc Alloy/锌合金
- Dead bolt/方舌: Brass/铜 Zinc Alloy/锌合金 Steel/铁
- Forend/面板: Brass/铜 Stainless steel/不锈钢 Steel/铁

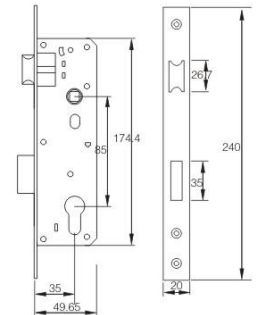

LOCK BODY SERIES



HT-8530S

TECHNICAL DATA

- Follower/方芯: 8mm
- Distance/中心距: 85mm
- Backset/门距: 30mm

FDREND

- Type/类型: Round head/圆头 Square head/方头
- Thickness/厚度: 2.5mm 3.0mm
- Width/宽度: 22mm
- Finishes/表面处理: NB/AB/PB/SN/CP/GP

MATERIAL

- Latch bolt/斜舌: Brass/铜 Zinc Alloy/锌合金
- Dead bolt/方舌: Brass/铜 Zinc Alloy/锌合金
Steel/铁
- Forend/面板: Brass/铜 Stainless steel/不锈钢
Steel/铁

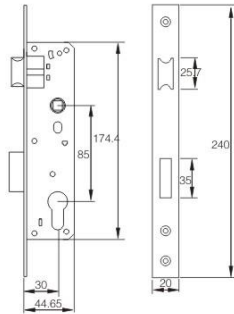

LOCK BODY SERIES



HT-DD8534

TECHNICAL DATA

- Follower/方芯: 8mm
- Distance/中心距: 85mm
- Backset/门距: 34mm

FDREND

- Type/类型: Round head/圆头 Square head/方头
- Thickness/厚度: 2.5mm 3.0mm
- Width/宽度: 22mm
- Finishes/表面处理: NB/AB/PB/SN/CP/GP

MATERIAL

- Latch bolt/斜舌: Brass/铜 Zinc Alloy/锌合金
- Dead bolt/方舌: Brass/铜 Zinc Alloy/锌合金
Steel/铁
- Forend/面板: Brass/铜 Stainless steel/不锈钢
Steel/铁

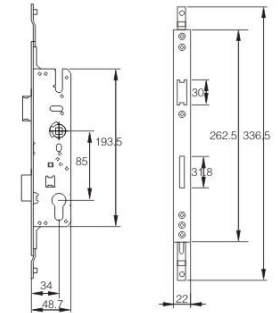

HT-8520S

TECHNICAL DATA

- Follower/方芯: 8mm
- Distance/中心距: 85mm
- Backset/门距: 20mm

FDREND

- Type/类型: Round head/圆头 Square head/方头
- Thickness/厚度: 2.5mm 3.0mm
- Width/宽度: 22mm
- Finishes/表面处理: NB/AB/PB/SN/CP/GP

MATERIAL

- Latch bolt/斜舌: Brass/铜 Zinc Alloy/锌合金
- Dead bolt/方舌: Brass/铜 Zinc Alloy/锌合金
Steel/铁
- Forend/面板: Brass/铜 Stainless steel/不锈钢
Steel/铁

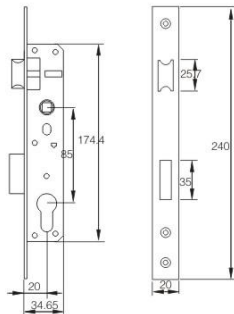

TECHNICAL DATA

- Follower/方芯: 8mm
- Distance/中心距: 92mm
- Backset/门距: 34mm

FDREND

- Type/类型: Round head/圆头 Square head/方头
- Thickness/厚度: 2.5mm 3.0mm
- Width/宽度: 22mm
- Finishes/表面处理: NB/AB/PB/SN/CP/GP

MATERIAL

- Latch bolt/斜舌: Brass/铜 Zinc Alloy/锌合金
- Dead bolt/方舌: Brass/铜 Zinc Alloy/锌合金
Steel/铁
- Forend/面板: Brass/铜 Stainless steel/不锈钢
Steel/铁

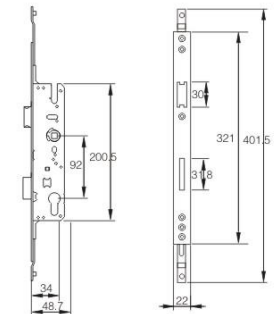

HT-DD9234

LOCK BODY SERIES



HT-753WC

TECHNICAL DATA

- Followee/方芯: 无
- Distance/中心距: 无
- Backset/门距: 40mm

FDREND

- Type/类型: Round head/圆头 Square head/方头
- Thickness/厚度: 2.5mm 3.0mm
- Width/宽度: 22mm
- Finishes/表面处理: NB/AB/PB/SN/CP/GP

MATERIAL

- Latch bolt/斜舌: Brass/铜 Zinc Alloy/锌合金
- Dead bolt/方舌: Brass/铜 Zinc Alloy/锌合金
Steel/铁
- Forend/面板: Brass/铜 Stainless steel/不锈钢
Steel/铁

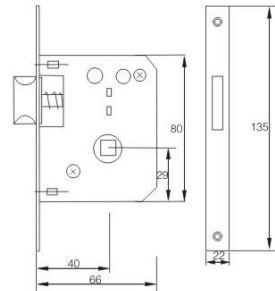

LOCK BODY SERIES



HT-150-40H



HT-267

TECHNICAL DATA

- Followee/方芯: 无
- Distance/中心距: 无
- Backset/门距: 60mm

FDREND

- Type/类型: Round head/圆头 Square head/方头
- Thickness/厚度: 2.5mm 3.0mm
- Width/宽度: 22mm
- Finishes/表面处理: NB/AB/PB/SN/CP/GP

MATERIAL

- Latch bolt/斜舌: Brass/铜 Zinc Alloy/锌合金
- Dead bolt/方舌: Brass/铜 Zinc Alloy/锌合金
Steel/铁
- Forend/面板: Brass/铜 Stainless steel/不锈钢
Steel/铁

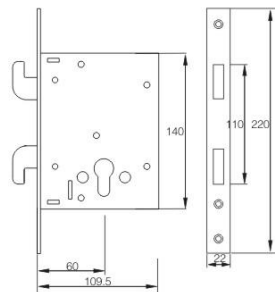

HT-5555H-S

LOCK BODY SERIES



001展板锁体

TECHNICAL DATA

- Follower/方芯: 8mm
- Distance/中心距: 85mm
- Backset/门距: 45mm

FDREND

- Type/类型: Round head/圆头 Square head/方头
- Thickness/厚度: 2.5mm 3.0mm
- Width/宽度: 22mm
- Finishes/表面处理: NB/AB/PB/SN/CP/GP

MATERIAL

- Latch bolt/斜舌: Brass/铜 Zinc Alloy/锌合金
- Dead bolt/方舌: Brass/铜 Zinc Alloy/锌合金
Steel/铁
- Forend/面板: Brass/铜 Stainless steel/不锈钢
Steel/铁

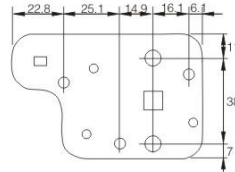

LOCK BODY SERIES



L6-45

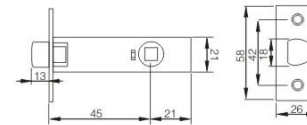

L6-60

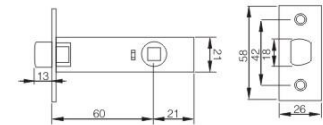

HT-3070X

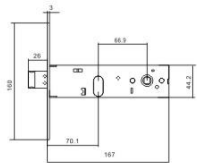

HT-3070

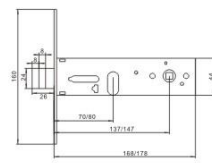

L7-45

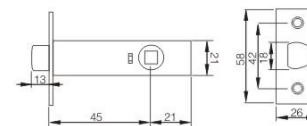

L7-60

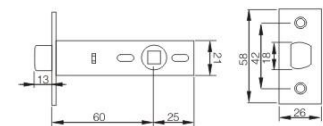

CYLINDER SERIES

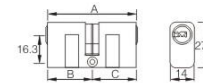

A:53/65
B:26.5/32.5
C:26.5/32.5

S2765-22 双开方锁芯

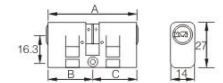

A:53/65
B:26.5/32.5
C:26.5/32.5

S2753-23 双开方锁芯

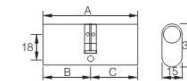

A:70
B:35
C:35

T3070-21 椭圆形70#单排
双开普通锁芯

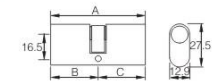

A:53
B:26.5
C:26.5

T2853-21 椭圆形53#单排
双开普通锁芯

CYLINDER SERIES



DNT80

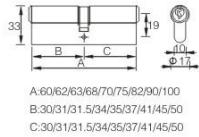

DDT60

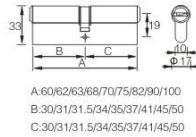

DDNT100

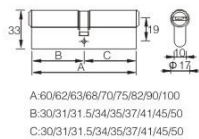

DDT70

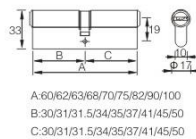

DNT100

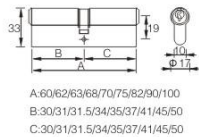

DTP70

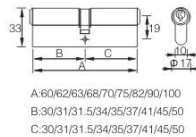

CYLINDER SERIES



DDX60

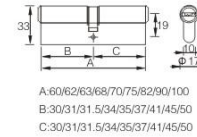

XX68

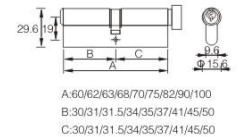

DX70

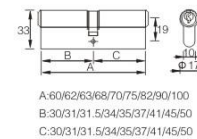

XX70B

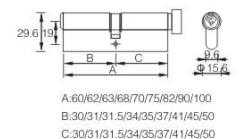

DDX70 A

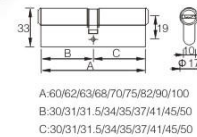

DXX70

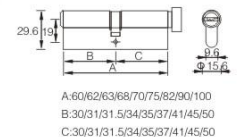

CYLINDER SERIES



DXNT70

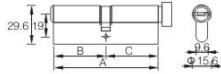

A:60/62/63/68/70/75/82/90/100
B:30/31/31.5/34/35/37/41/45/50
C:30/31/31.5/34/35/37/41/45/50



DDX70 B

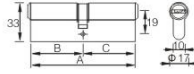

A:60/62/63/68/70/75/82/90/100
B:30/31/31.5/34/35/37/41/45/50
C:30/31/31.5/34/35/37/41/45/50



DXT70 B

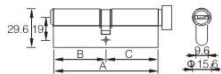

A:60/62/63/68/70/75/82/90/100
B:30/31/31.5/34/35/37/41/45/50
C:30/31/31.5/34/35/37/41/45/50



C3345-00
大45#半边通道锁芯

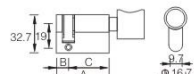

A:40/50/55/60
B:10/10/10/10
C:30/35/40/50



DXT70 C

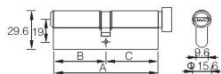

A:60/62/63/68/70/75/82/90/100
B:30/31/31.5/34/35/37/41/45/50
C:30/31/31.5/34/35/37/41/45/50



C3370-00
大70#BK锁芯

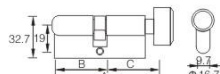

A:40/50/55/60/70/80
B:20/25/27.5/30/35/45
C:20/25/27.5/30/35/45

TURN KNOB SERIES



CYLINDER SYSTEM

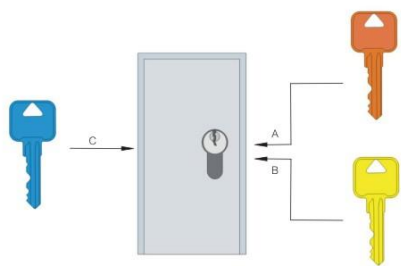

使用说明

- A: 工程钥匙, 是安装工人在进行工程安装调试时使用的钥匙。
- B: 业主钥匙, 是业主在工程安装调试完后, 正常使用的钥匙。
- C: 是用来失效A钥匙的, 一般由业主持有。装修完后, 业主收回A钥匙, 并启用C钥匙。将C钥匙插入锁芯旋转180度; 回转动出C钥匙带出钢珠, A钥匙失效。拔出后复检A钥匙, 确认A钥匙已完全失效, 然后将A、C钥匙一并销毁。

二级管理系统锁芯

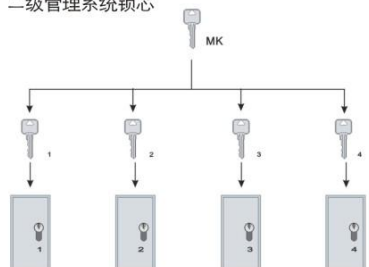

二级管理系统锁芯中的每把锁都有其独立钥匙, 但所有的锁都可由一把总钥匙-锁王钥匙MK开启

KEY SERIES



COLOR CODE

FINISHES 表面处理



青古铜AB
Antique Brass



红古铜AC
Antique Copper



钢拉丝BB
Brass Brushed



镀铬CP
Chrome Plated



镀镍NP
Nickel Plated



镍拉丝NB
Nickel Brushed



砂镍SN
Satin Nickel



砂铬SC
Satin Chrome



仿金GP
Gold Plated



铜抛光PB
Polished Brass

DIN LEFT HAND

Visible position of the door hinges on the left

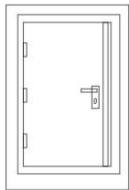

OPENING OUT
外开门

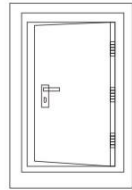

OPENING IN
内开门

DIN 左开门

人在门开门方向的外侧且面向门，门的转轴在左边的开门方向。



The straight side of the latch points to the left
从锁体面板正面看，锁体斜舌直面在左边

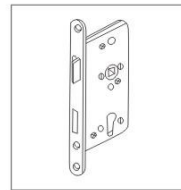

The straight side of the latch points to the right
从锁体面板正面看，锁体斜舌直面在右边

DIN RIGHT HAND

Visible position of the door hinges on the left

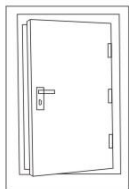

OPENING OUT
外开门

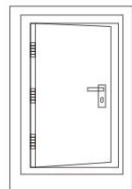

OPENING IN
内开门

DIN 右开门

人在门开门方向的外侧且面向门，门的转轴在左边的开门方向。

